

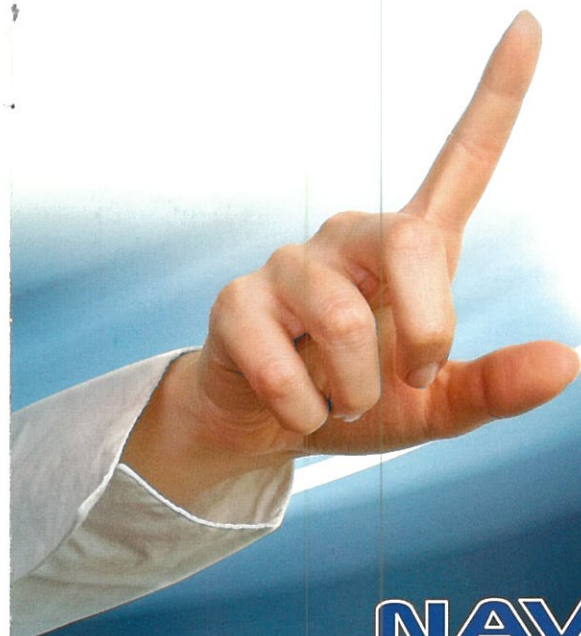

\$15



SOLARVAC-SOLAMAGIC
3/37 Howe St Osborne Park WA
Ph: 9244 4611 Fax: 9446 7339
www.(&info@)solarvac.com.au



NAVIGATOR

Touch Screen Keypad

USER'S MANUAL

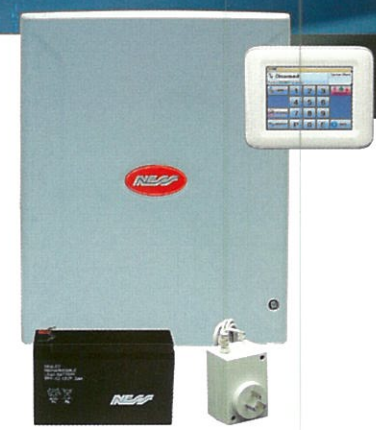

D8x/D16x Navigator Alarm Control Panels V7
Operation and User Programming Manual





www.nesscorporation.com

National Customer Service Centre
Ph: 1300 551 991

D8x/D16x Navigator USER Manual
Rev 2.1, April 2013

Document Part No: 890-402



WARNINGS & NOTICES

Ness Corporation manufacturing processes are accredited to ISO9001 quality standards and all possible care and diligence has been applied during manufacture to ensure the reliable operation of this product. However there are various external factors that may impede or restrict the operation of this product in accordance with the product's specification.

These factors include, but are not limited to:

1. Erratic or reduced radio range (if radio accessories are installed). Ness radio products are sophisticated low power devices, however the presence of in-band radio signals, high power transmissions or interference caused by electrical appliances such as Mains Inverters, Wireless Routers, Cordless Phones, Computers, TVs and other electronic devices may reduce radio range performance. While such occurrences are unusual, they are possible. In this case it may be necessary to either increase the physical separation between the Ness receiver and other devices or if possible change the radio frequency or channel of the other devices.
2. Unauthorised tampering, physical damage, electrical interruptions such as mains failure, electrical spikes or lightning.
3. Solar power inverters are a known source of electrical interference. Please ensure that this product and all associated cabling is installed at least 3 metres away from a solar power inverter and its cabling.

WARNING: Installation and maintenance to be performed only by qualified service personnel.

CAUTION: Risk of explosion if battery is replaced by an incorrect type. Dispose of used batteries in accordance with local regulations.

ADSL NOTICE: ADSL broadband data can interfere with the operation of your alarm dialler. It is recommended that a quality ADSL filter be installed as per the filter manufacturer's guidelines in premises with an alarm dialler installed.

COPYRIGHT NOTICE

All rights reserved. No part of this publication may be reproduced, transmitted or stored in a retrieval system in any form or by any means, electronic, mechanical, photocopying, recording, or otherwise, without the prior written permission of Ness.

Ness reserves the right to make changes to features and specifications at any time without prior notification in the interest of ongoing product development and improvement.

© 2013 Ness Corporation Pty Ltd ABN 28 069 984 372



NAVIGATOR

- Navigator D8x panel
- Navigator D16x panel

TIMERS

ENTRY DELAY TIME 1	<input type="text"/>	Seconds
ENTRY DELAY TIME 2	<input type="text"/>	Seconds
EXIT DELAY TIME	<input type="text"/>	Seconds
SIREN TIME	<input type="text"/>	Minutes

ZONE ASSIGNMENT

Installer programming options

- P41E ENTRY DELAY 1
- P43E ENTRY DELAY 2
- P42E HANDOVER
- P40E INSTANT
- P45E AREA 1
- P46E AREA 2
- P51E MONITOR
- P52E 24 HOUR
- P54E RESET OUTPUT
- P55E STROBE OUTPUT
- P56E SONALERT OUTPUT
- P57E SIREN OUTPUT
- P74E Report (dialler)

DATE PURCHASED:	DATE INSTALLED:
INSTALLATION COMPANY:	
TELEPHONE:	
MONITORING COMPANY:	
TELEPHONE:	

ZONES	DEVICE TYPE	PIR, Reed switch, etc	DESCRIPTION	Entrance, bedroom1, etc	P41E	P43E	P42E	P40E	P45E	P46E	P51E	P52E	P54E	P55E	P56E	P57E	P74E
D8 & D16	1																
	2																
	3																
	4																
	5																
	6																
	7																
	8																
D16	9																
	10																
	11																
	12																
	13																
	14																
	15																
	16																

USER CODE	OPTION No	Extra Options Assigned E.g. Radio Code, Arm Only, etc.
1 Master Code	P201E	
2	P202E	
3	P203E	
4	P204E	
5	P205E	
6	P206E	
7	P207E	
8	P208E	
9	P209E	
10	P210E	
11	P211E	
12	P212E	
13	P213E	
14	P214E	
15	P215E	
16	P216E	
17	P217E	
18	P218E	
19	P219E	

USER CODE	OPTION No	Extra Options Assigned E.g. Radio Code, Arm Only, etc.
20	P220E	
21	P221E	
22	P222E	
23	P223E	
24	P224E	
25	P225E	
26	P226E	
27	P227E	
28	P228E	
29	P229E	
30	P230E	
31	P231E	
32	P232E	
33	P233E	
34	P234E	
35	P235E	
36	P236E	
37	P237E	
38	P238E	

USER CODE	OPTION No	Extra Options Assigned E.g. Radio Code, Arm Only, etc.
39	P239E	
40	P240E	
41	P241E	
42	P242E	
43	P243E	
44	P244E	
45	P245E	
46	P246E	
47	P247E	
48	P248E	
49	P249E	
50	P250E	
51	P251E	
52	P252E	
53	P253E	
54	P254E	
55	P255E	
56	P256E	

SYMPTOM	POSSIBLE CAUSE	REMEDY
When arming, a zone light is on or the keypad gives a long beep.	One or more detection device (a PIR or reed switch) may be <i>unsealed</i> .	Find the cause of movement or close the door or window.
<ul style="list-style-type: none"> • 10 beeps from keypad. • MAINS light is flashing. • BATTERY light is flashing. 	The mains power may be off, ...or the panel's backup battery may be low, ...or a Radio Device battery may be low.	Make sure the plug pack is plugged in and the power point is turned on. The backup battery may need replacing, call your installer.
1 long beep from the keypad.	Invalid keypad entry.	Press the E button and try again.
2 second siren at the end of Exit Delay time.	A zone was <i>unsealed</i> at the end of exit delay time.	Disarm the panel and check all zones.
The strobe light is flashing.	There has been an alarm within the last 72 hours.	Reset the alarm by disarming the panel and check the Alarm Memory
Siren sounds while the panel is disarmed.	A 24 hour zone has been alarmed. (Siren Tamper, Box Tamper, Panic Button).	Reset the alarm by disarming the panel and call your installer.
EXCLUDE is flashing.	A zone/s has been Excluded.	This is to indicate that one or more zones have been Excluded.
Cannot arm and EXCLUDE is displayed.	You are in Exclude mode.	Press E to exit Exclude mode.
System Alarm TAMPER ALARM is flashing	The 24 hour Tamper input has alarmed. (Siren tamper or box tamper).	Call your installer.
MEMORY is flashing.	There are alarms in memory.	To clear the ALARM MEMORY, view the Alarm memory otherwise the light will clear next time you arm the panel.
Cannot enter Program Mode.	The panel is armed. Or you may be attempting to enter program mode using one of the user codes.	Disarm the panel before attempting to enter Program Mode. Try again using the Master Code.
When I arm by radio key, ARMED on the keypad does not turn on immediately.	The panel is waiting 5 seconds for a second press of the ON button to enter Home mode.	This is normal operation when arming of Home mode by radio key is enabled.
The keypad is making a continuous slow beep.	This is the AutoTime warning beep which can be programmed to start from 1 to 99 minutes before an AutoTime event is due to begin.	The beeps will continue during the AutoTime warning period changing to faster beep in the final minute prior to the AutoTime event.
The panel re-arms itself a short time after disarming.	Auto Re-Arm is enabled.	Enter the premises after disarming. Auto Re-Arm is designed to re-arm the panel if you don't enter the premises after disarming.

Introduction	4
Navigator System overview	5
Navigator Touch Screen Keypad overview	6
Information Screen	7
Care & Cleaning	8
Applying the Protective Film	9
Zone Status Display	10
Clock Display	11
System Alarm Displays	12, 13
Arming the System	14
Disarming the System	15
Home Mode	16
Duress Alarm	17
Emergency Alarms	18
Excluding Zones	19
Event Memory	20
Day Mode Setup	21
Day Mode Operation	22
Auto Time Automation	23
Auxiliary Outputs, Manual Operation	24
Programming	25
How to enter program mode	26
Set Brightness, Set Volume	27
Edit Zone Names, Edit AUX Output Names	28
Zone Name Library	29
Setting the Real Time Clock	30
User Codes Options Table	31
User Codes Programming	32
Radio Keys Programming	33
Timer Programming, Entry/Exit Delays	34
Follow Me Telephone Number Programming	35
Monitoring Operation	36
Remote Operation by Telephone	37
Troubleshooting	38
Installation Record	39

Introduction

The Ness Navigator is a revolutionary touch screen interface for use with the Ness D8x/D16x¹ series alarm control panels.

Navigator has a large touch sensitive 3.5" colour LCD which is easy to read, easy to use and makes operating your Ness alarm system a real pleasure.

The large colour screen means Navigator can tell you much more than a conventional keypad can.

Zone descriptions are displayed in plain English and you can even edit zone

names yourself to reflect the names of rooms in your own premises.

Not only does Navigator provide valuable information about your Ness alarm system, it allows you to arm and disarm your system, tells you what the system is doing, you can use it to program alarm system and if that's not enough - Navigator just looks great!



¹ Navigator Touch Screen Keypad is compatible with Ness D8x and D16x control panels Version 7 and later.

Telephone Remote Operation

ARM /DISARM AND OPERATE AUX OUTPUTS BY PHONE

Ness Navigator control panels allow a user to call in to the panel, using a standard DTMF telephone, and remotely arm or disarm all areas and also turn on or off the Auxiliary outputs.

To maintain panel security, remote operations can only be activated after entering a valid user code.

To operate the panel by telephone, you need a DTMF capable telephone, a valid user code and you must know the telephone number of the line to which the panel is connected.

Notes

- If the panel does not receive commands for periods longer than 10 seconds it will assume that the call is finished and it will hang up.
- If an alarm occurs which requires the panel to dial out while attempting remote control, the panel will treat the alarm as a priority, give a constant tone as a warning and then hang up.

AUDIBLE FEEDBACK

🎵 3 BEEPS

- The User Code is valid
- Successful arm or disarm
- An AUX output has been turned ON.

🎵 1 LONG BEEP

- Panel is already armed
- Invalid code. Try again.
- Remote AUX operation is not enabled

🎵 1 SHORT BEEP

- An AUX output has been turned OFF.

SEQUENCE OF OPERATION.

1. Phone the panel telephone number and listen for the required number of rings and then hang up.
2. Wait 10 seconds and then call the number again within 50 seconds.
3. The panel will answer the second call immediately, sound a beep for 2 seconds then, after a pause, it will sound a lower frequency tone. The panel is now ready to receive telephone commands.
4. Press the **[0]** button on the telephone. This tells the panel that telephone commands will follow. The panel will respond with either 3 beeps if all OK (One long beep means try again).
5. Now enter a valid User Code (that is normally used for arming or disarming the panel) followed by the **#** button.
The panel will respond with 3 beeps if it recognises the code or 1 long beep to signal the code was invalid and to try again.
6. Enter the required command. See the summary of telephone commands below.
7. Press **[*] [#]** to finish. This tells the panel to hang up. Also hang up your telephone.

TELEPHONE COMMANDS

[0]	Prepare to receive commands
[1] [#]	Arm Areas
[2] [#]	Disarm Areas
[1] [1] [*]	Turn ON or Pulse AUX1
[1] [1] [#]	Turn OFF AUX1
[2] [2] [*]	Turn ON or Pulse AUX2
[2] [2] [#]	Turn OFF AUX2
[3] [3] [*]	Turn ON or Pulse AUX3
[3] [3] [#]	Turn OFF AUX3
[4] [4] [*]	Turn ON or Pulse AUX4
[4] [4] [#]	Turn OFF AUX4
[*] [#]	Finished – hang up

Monitoring

CENTRAL STATION MONITORING



Ness Navigator control panels have a digital dialler which can send detailed alarm messages to a Central Monitoring Station.

The digital messages can include information about the zone or zones which caused the alarm, tamper alarms, low battery or

mains failure reports, and it can also (by user number) identify the users who arm and disarm the system.

Central station monitoring is highly recommended and is the most effective method of monitoring your alarm system.

For further information about 24 hour monitoring, contact your installer or Ness Corporation.



AUDIBLE MONITORING

As a lower security alternative to central station monitoring, the panel can be programmed to send audible messages to a fixed or mobile phone.

When programmed for audible monitoring, the panel calls a pre-programmed number (or numbers) and sounds an audible alarm message and a series of beeps over the phone. These beeps can identify the zone or zones which caused the alarm as well as several other alarm types.

THE AUDIBLE MESSAGE

When triggered by an alarm, the panel will dial the programmed telephone number/s and output the audible message "ALARM, ALARM, ALARM" and beeps for 45 seconds or until it is acknowledged.

THE "FOLLOW ME" TELEPHONE NUMBER

If your panel is programmed for Audible Monitoring, it will make alarm calls to the Primary and Secondary telephone numbers programmed by your installer.

If a Follow Me Telephone Number is programmed, the Primary and Secondary telephone numbers will be ignored. All alarm calls will be sent to the Follow Me Telephone Number.

If your panel is monitored by a Central Station, the Follow Me number is ignored.

ACKNOWLEDGING THE ALARM

The person receiving the call can acknowledge the alarm by pressing the **3** key on their telephone.

Press the **3** key during gaps in the alarm message.

Once you successfully acknowledge the alarm the panel will hang up and not ring any other telephone numbers until the next alarm.

If you do not acknowledge the alarm the panel will ring you again and then it will ring the next programmed telephone number, (if any).

Note: If the alarm is not acknowledged, the LINE light on the Navigator keypad will display a Dialler Communications Fault until the panel is next armed.

Your Navigator System

Your Ness Alarm System

Ness Navigator Touch Screen Keypad is the face of your Ness D8x or D16x Navigator Alarm System.

Navigator's self-explanatory operation guides provide you with plain English displays and intuitive touch screen operation.

The interactive display screens make it easy to view all your zones with your own text descriptions, get help and prompts for arming, disarming, operating outputs, emergency alarms and more.

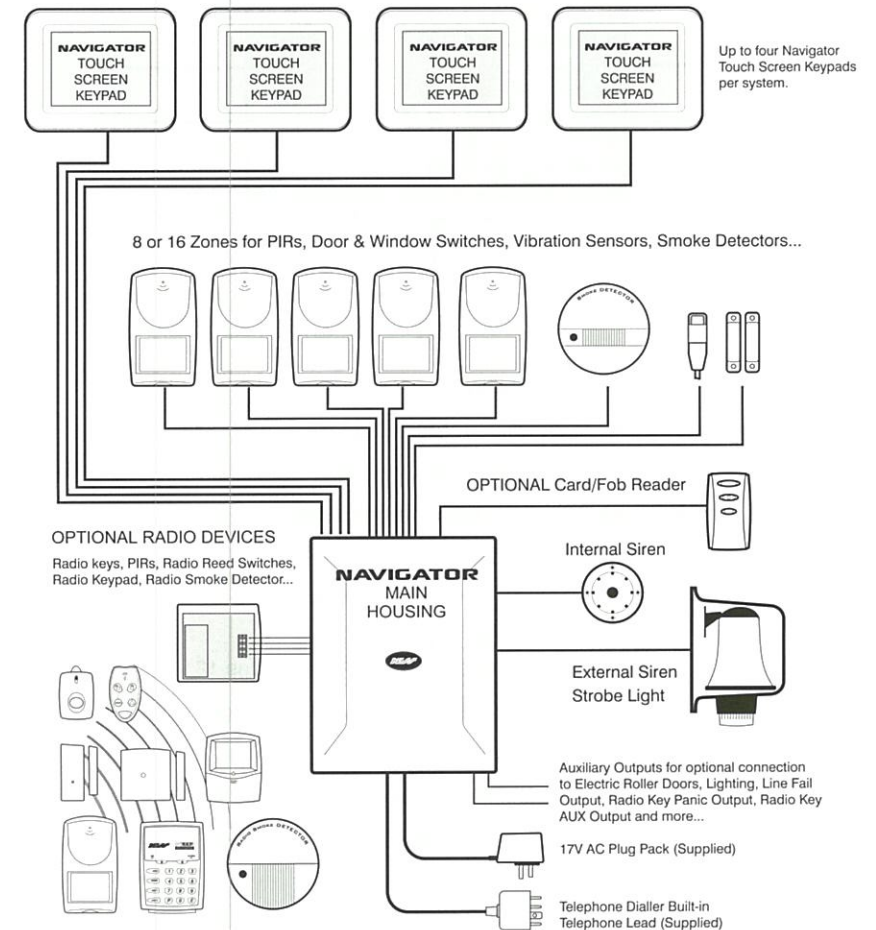

Overview

The Disarmed Screen

In the normal disarmed mode, the Navigator screen displays information about the state of your system and gives you instant access to commonly used functions.

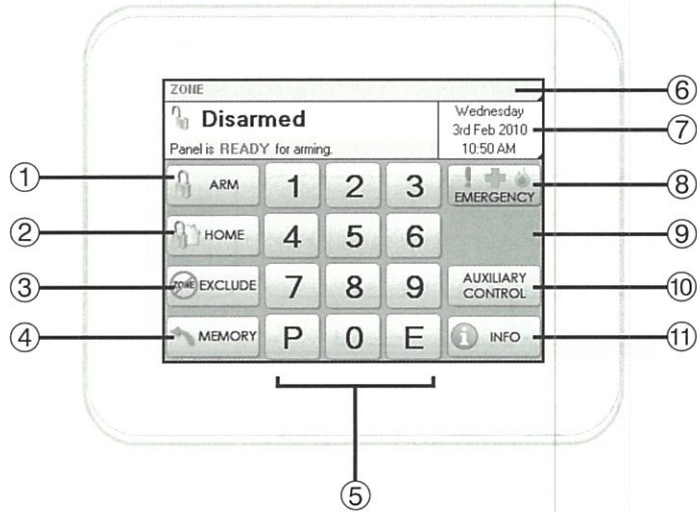

- ① Touch to arm the system. Page 14.
- ② Touch to arm Home Mode. Page 16.
- ③ Touch to Exclude zones. Page 19.
- ④ Touch to view the event memory. Page 20.
- ⑤ Numeric keypad.
- ⑥ Touch to view the full zone list. Page 10.
- ⑦ Touch here to view the calendar. Page 11.
This area also displays System Alarms. Page 12.
- ⑧ Touch to activate the Emergency Alarms. Page 18.
- ⑨ This area displays current Emergency Alarms.
- ⑩ Touch to control the Auxiliary Outputs. Page 24.
- ⑪ Touch to display the information screens. Page 7.

Programming - Follow Me Telephone Number

This option allows you to program:

FOLLOW ME TELEPHONE NUMBER

If your panel is set up for Audible Voice monitoring, you can program the Follow Me Telephone Number to temporarily replace the two installer-programmed phone numbers.

If the Follow Me Telephone Number is blank the panel will report alarms to the Primary and Secondary phone numbers if they have been programmed by your installer.

Use the Pause, star or hash keys to enter special characters if required. For example, if your phone system requires you to dial zero to pick up the line, press 0 followed by the Pause button then enter the phone number you want the panel to dial in the event of an alarm.

The option number and the current phone number is displayed.

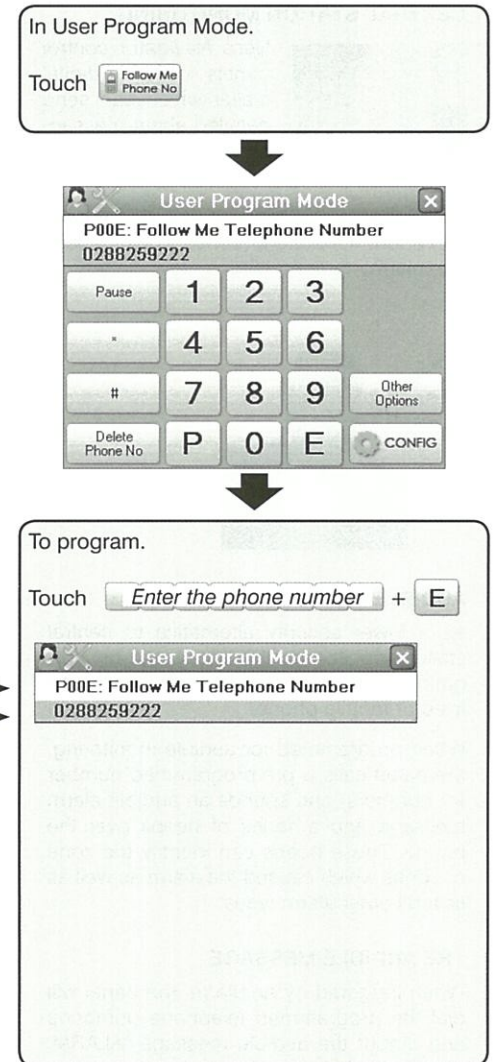

Programming Timers

This option allows you to program:

ENTRY DELAY TIME 1 (01-99 sec)
Entry Delay Time 1 sets the time allowed to enter the premises through a delay zone.

ENTRY DELAY TIME 2 (01-990 sec)
If enabled by your installer, this timer is used to give extra long entry delay on selected zones. Entry Delay Time 2 is internally multiplied by 10. For example, enter 12 to get a time of 120 seconds.

EXIT DELAY TIME (01-99 sec)
Exit Delay Time sets the time allowed to exit the premises after arming. All zones, except 24hr zones, are inactive during the Exit Delay Time.

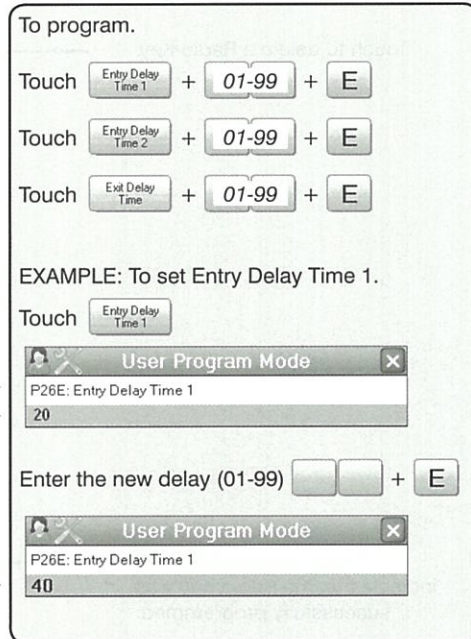
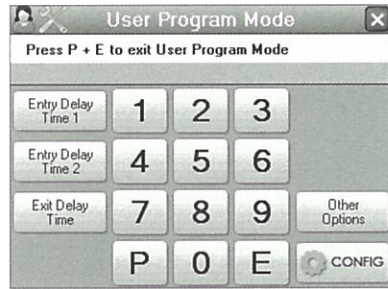
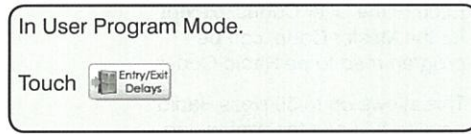

The option number and the current delay time is displayed.

The new delay time is displayed.

Info Screen

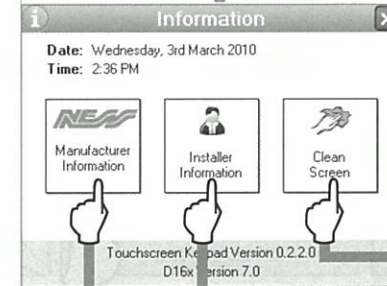
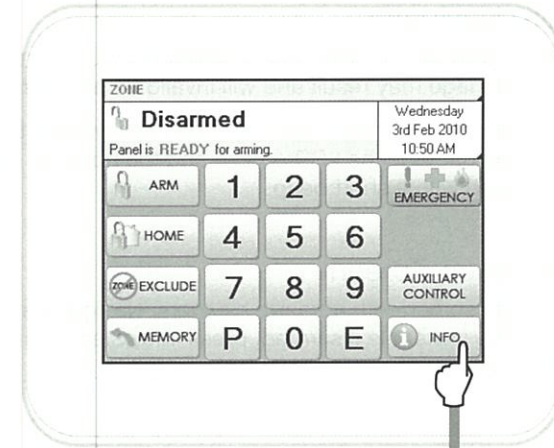

See page 8.



Ness Corporation contact details.



Your installer's contact details are stored here. Never lose a business card again!

Care & Cleaning

Caring for your Navigator

Do not use a pen, screwdriver or other sharp implement to press the touch screen. Permanent damage may result and will invalidate any warranties.

Please press lightly, the touch screen does not need heavy force to operate. Pressing too hard may damage the LCD screen and the housing. Navigator responds to every touch with a short beep.

Cleaning The Touch Screen

Do not clean the touch screen with abrasive cleaners. Navigator's Clean Screen page. While the system is disarmed, press Info, Clean Screen to see the cleaning instructions.

STEP 1. In the disarmed mode, press *Info*.

STEP 2. Press *Clean Screen*.

STEP 3. Press *Start*.

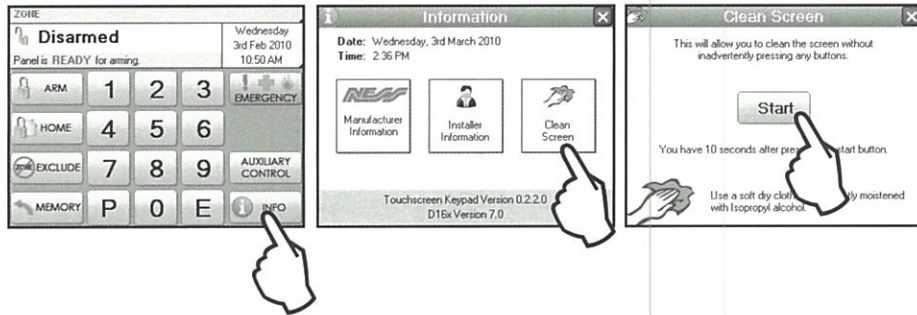

Step 4. The touch screen will be disabled for 10 seconds. Clean the bare screen or the protective film using a soft dry cloth or a cloth moistened with Isopropyl Alcohol. Avoid chemical cleaners and solvents which may damage plastic components.

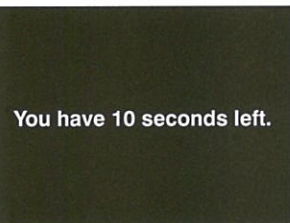

Programming Radio Keys

Each of the User Codes, except for the Master Code, can be programmed to be Radio Codes.

This allows up to 55 Ness Radio Keys to be used for arming and disarming of the panel.

The optional Ness Radio Interface is required for radio operation. Ask your installer.

Indicates that this code has been enabled as a Radio Code. If the option has been enabled by your installer.

Touch to delete a Radio Key.

The green status bar will indicate that the Radio Key was successfully programmed.

If you hear a long beep, the Radio key may already be programmed at another user code.

In User Program Mode.
Refer to the User Code options table on page 31 then enter the option number of the user code you want to program.
Touch **P** + + **E**
3 digit option number
Example, P203E



Touch **Program Radio Code**
The display will show Ready to Receive
Press the disarm button on your Ness Radio Key (or the No. 1 button).



Programming User Codes

In User Program Mode.
Refer to the User Code options table on page 31 then enter the option number of the user code you want to program.

Touch **P** + + **E**
3 digit option number

The option number and the current user code is displayed.



Now enter your new user code (PIN). The code can be 3 to 6 digits in length.

Touch + **E**
Your new PIN

Then enter the PIN again to confirm.

Touch + **E**
Your new PIN

Note 1. User codes must NOT start with zero. (The panel will allow codes beginning with zero to be programmed but they will not operate the panel. This is an alternative method for disabling user codes.)

Note 2. All codes must be unique to each other. Codes are rejected if already used. Some codes that are similar to existing codes may also be rejected.

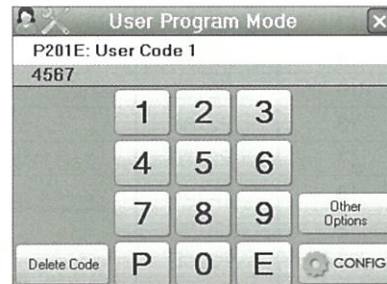

Touch to delete a user code.

The new user code will be displayed.



ARM ONLY CODES

 **Arm Only Code** If a code has been programmed by your installer to be an Arm Only code, then that user code can arm but not disarm the panel. This is handy for cleaners, temporary staff etc.

Screen Protection

Applying the Protective Film

Navigator Touch Screen Keypad is supplied with a self-adhesive screen protector to help protect the sensitive touch surface from marks and scratches which may appear under normal use.

We highly recommend that you apply the protective film to keep the touch surface looking brand new for years to come.

STEP 1. Use the orange No. 1 tab to peel off the self-adhesive backing.

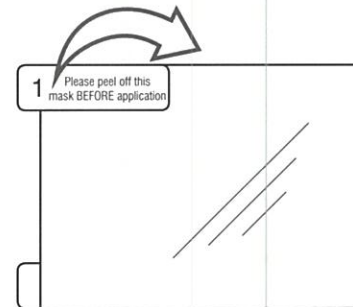

STEP 2. Flip the film over to position the green No. 2 tab at the top left.

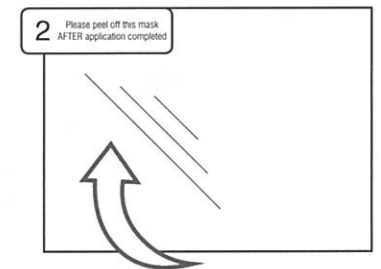

STEP 3. Holding the protective film by the green tab, carefully apply the film to the Navigator's screen. Start applying at one end and smooth the film as you go to remove any air bubbles.

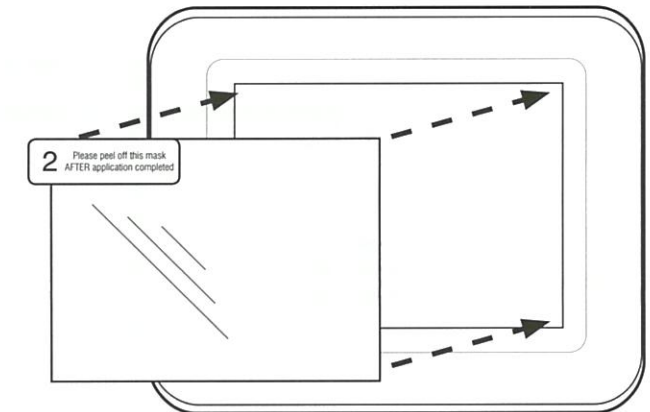

STEP 4. Use the green tab to peel off and discard the topmost layer of the film. Your Navigator is now ready for use.

Emergency Alarms

PANIC ALARM

The Panic alarm may have been programmed to be either Audible to activate the sirens, or Silent to send a PANIC report by dialler if your system is monitored by a Central Station.

The Emergency Alarm display will show Medical and Fire alarms only if they have been enabled by your installer.

The Medical alarm sends a medical alarm report by dialler if this option has been enabled by your installer and the system is monitored by a central station.

The Medical Alarm does not sound the sirens.

The Fire alarm sounds the siren using the Fire Alarm sound and sends a Fire Alarm report by dialler. If this option has been enabled by your installer and the system is monitored by a central station.

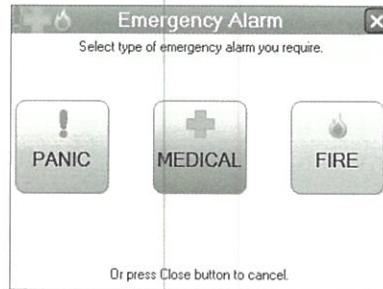
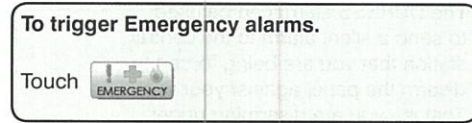

If the Panic Alarm Shortcut is not enabled, you are required to enter your user code + E to trigger the panic alarm.

Touch **X** to close the window.

Auto Time

Auto Time - automating your Navigator security system.

Your D8x/D16x Navigator panel features sophisticated automation features making full use of the onboard Real Time Clock and a set of powerful yet simple to program options.

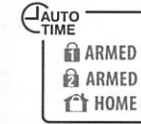

ARM or DISARM AUTOMATICALLY at pre-programmed times of day or day of the week.

Increase site security. No need to rely on staff remembering to arm or disarm the system.

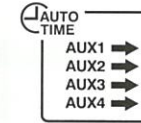

TURN AUX OUTPUTS ON or OFF at pre-programmed times - every day, once a week, any time. Automate doors, sprinkler systems, lights and more.



ENABLE/DISABLE USER CODES depending on the time of day or day of the week. Allows managers to grant users access to the system at selected times and deny after hours entry.

AUTO TIME WARNING PERIOD

(Optional function - must be enabled by your installer.)

When an Auto Time event is about to begin, your keypad (or keypads) will begin a constant slow beep as a warning that the automatic event is about to happen. The warning beeps can be programmed to start up to 99 minutes prior to the AutoTime event.

Press any key on the keypad to stop the beeps during the warning period. The beeps will start again for the final minute at a faster rate.

Final Minute beeps. In the last minute prior to the Auto Time event, the keypad will beep at a faster rate to warn that the event is about to start.

TO DELAY THE AUTO TIME EVENT

(Optional function - must be enabled by your installer.)

To delay the Auto Time event, enter a valid user code on its own. (The user code must be assigned to an Area to work). This will suspend the warning beeps and the AutoTime event for 1 hour - when the warning process will start again.

Example: Your panel is programmed to Auto Arm at 6pm every weekday and the Warning Period is programmed for 5 minutes. You are working back late and at 5:55pm your keypad begins to beep. Since you're not ready to arm the system yet, enter your user code (without pressing E) at the keypad. The warning beeps will stop and arming will be delayed by one hour. At 6:55pm the warning beeps will start again, followed by automatic arming if you don't delay the event again.

Any AutoTime event can be postponed, not just arming. You can also delay the automatic turn (or off) of one of the AUX outputs in the same manner.

Day Mode - Operation

This enables/disables both Temporary and Permanent Day Zones.

When Day Mode is enabled, any unsealed day zone will sound the programmed output for 2 seconds. When Day Mode is disabled, an unsealed day zone will simply be indicated on the keypad as an unsealed zone.

Day Mode can be enabled when the panel is in the normal disarmed mode.

To enable Day Mode.

Touch 0 + E

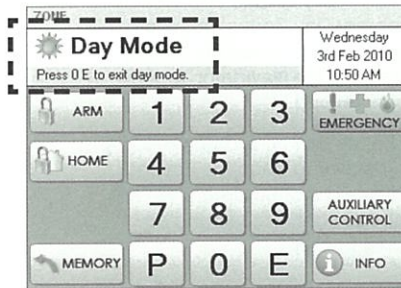

To disable Day Mode.

Touch 0 + E

Excluding Zones

If there is a problem with a detection device and the zone cannot be sealed when arming the panel, then that zone can be manually Excluded so that it does not generate alarms.

When zones have been Excluded, the EXCLUDE light flashes continuously while the panel is disarmed and also when armed.

Zones can be excluded while the panel is either disarmed or armed. See notes below.

Zone Exclude is not permanent. Excluded zones are automatically included next time the panel is disarmed.

To Exclude zones.

Touch 

Then touch the zone name/s to toggle the exclude status for one or more zones.

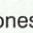
Excluded zones are indicated by the  icon.

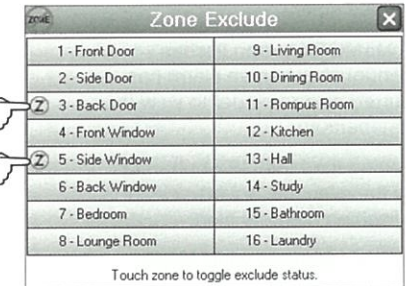

Touch  to close the window.

Flashing →

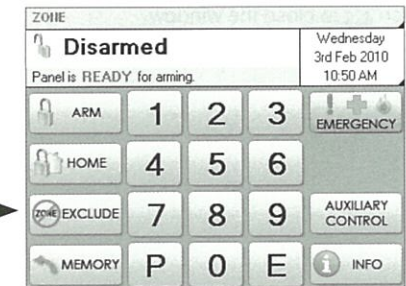

In both disarmed and armed modes, the Zones Excluded icon flashes to indicate that there are zone/s excluded.

Flashing →

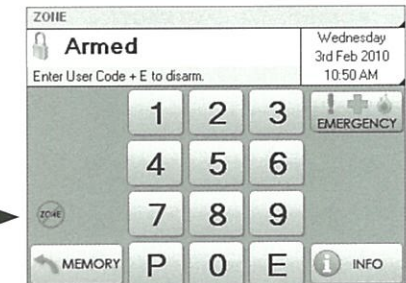

Event Memory

The panel stores a comprehensive event memory, including Arming, Disarming, Low Battery, Mains Fail and Alarm events.

The memory is constantly upgraded and the last 80 events with time & date are always available for viewing.

This memory display can only be selected while the panel is in the disarmed state.

The MEMORY button flashes continuously when an alarm has occurred as a reminder to view the alarm memory.

Touching the MEMORY button to view the event history also clears the flashing memory alert.

The Event Memory window will close automatically when the last event has been viewed.

Touch  to close the window.

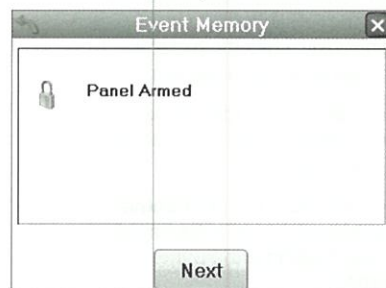
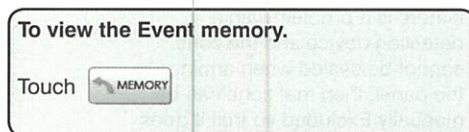

Press Next to view the event memory from most recent to oldest.



There is no need to refer to charts or tables - the event memory describes exactly what you're viewing, in plain English.

Day Mode - Set up

Your Navigator control panel has a Temporary Day Zone feature which allows easy and flexible Day Zone selection and operation.

Temporary Day Zones operate in addition to Permanent Day Zones which are usually set up by your installer.

You can easily enable and disable Temporary Day Zones and even program which zones will be Day Zones from the Navigator Touch Screen keypad.

Day Zones can be programmed by your installer to beep the keypad, or briefly sound the siren/s or flash the strobe light, or to sound an optional buzzer.

TYPICAL APPLICATIONS

Day Zones are useful for a variety of applications such as a shop door beeper triggered by a reed switch on the door.

For example, in a shop situation you can use Day Mode to alert you when a customer enters the front door.

You can also use Temporary Day Zones to monitor switches on, for example, the rear door or the fridge doors.

Note for installers and advanced users: Permanent Day Zones are not displayed in selection mode. Permanent Day Zones can be selected as Temporary Day Zones but this has no effect as those zones are already day zones.

Touch  to close the window.

Select which zones will be Temporary Day Zones. You probably will only need to do this once or occasionally.

To enter Temporary Day Zones selection.

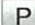
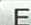
Touch  + 

Then touch the zone name/s you want to enable or disable as Day Zones.

Selected zones are indicated by the  icon.

